

SANREMO RACE LOCK

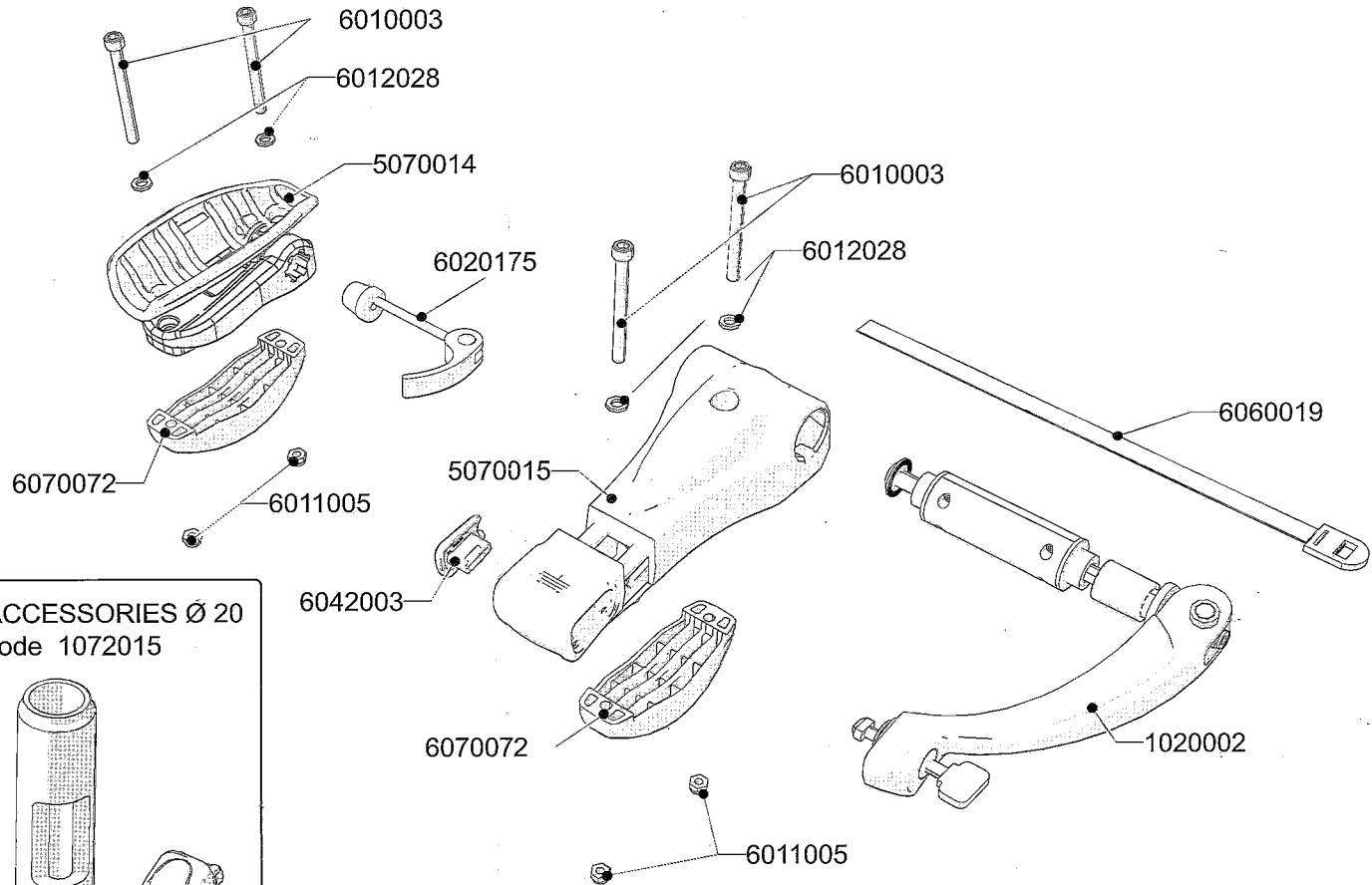

ACCESSORIES Ø 15
code 1072014

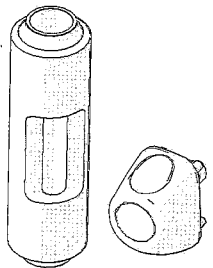

ACCESSORIES Ø 20
code 1072015

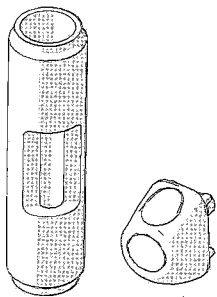

ELITE_1703_3114LP

SANREMO RACE LOCK

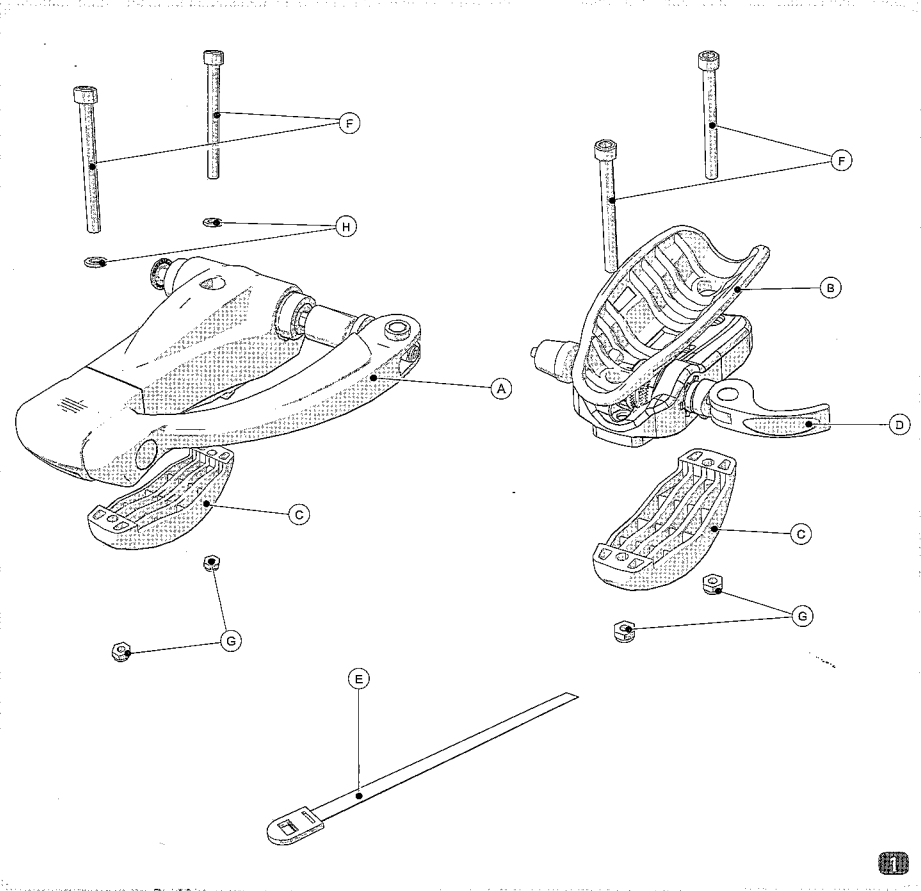

elite-it.com

ELITE srl - 35014 Fontaniva (PD) - ITALY - Fax +39 049 594 0064 - e-mail: contatto@elite-it.com



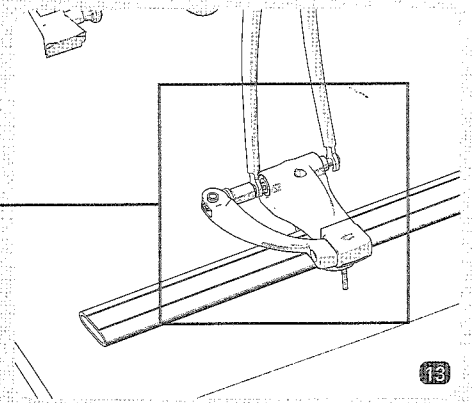
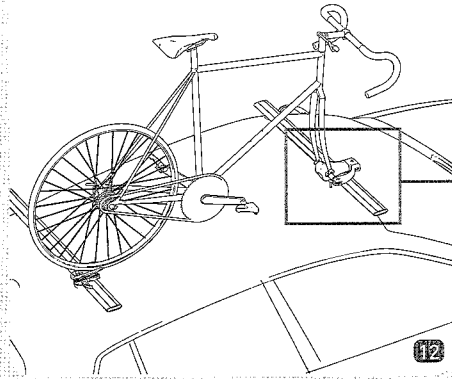
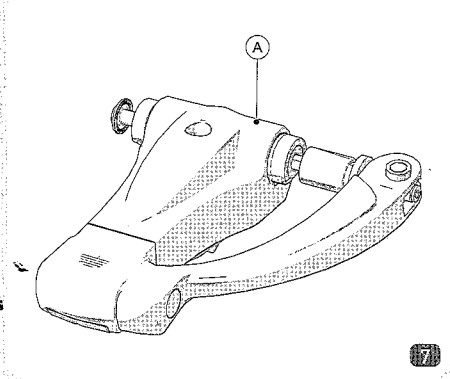
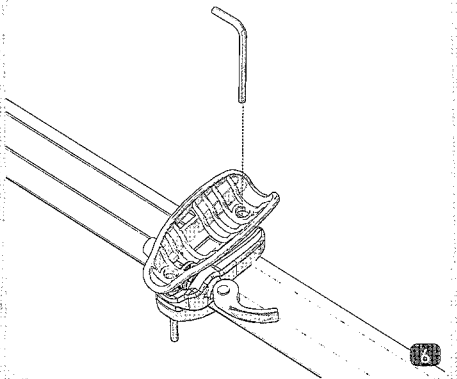
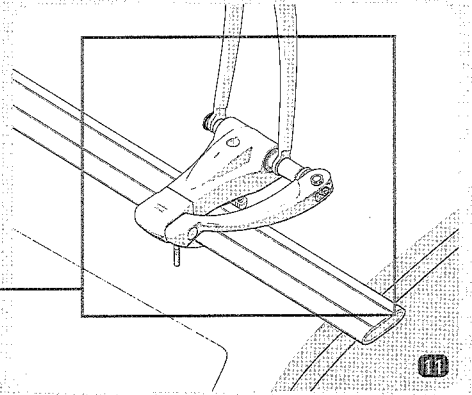
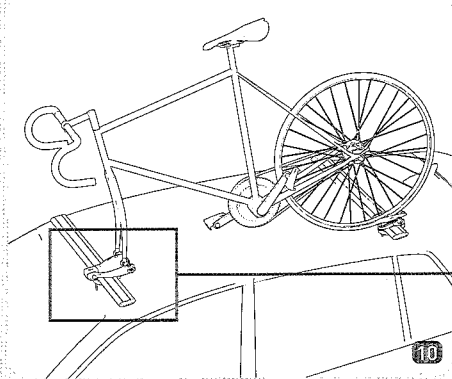
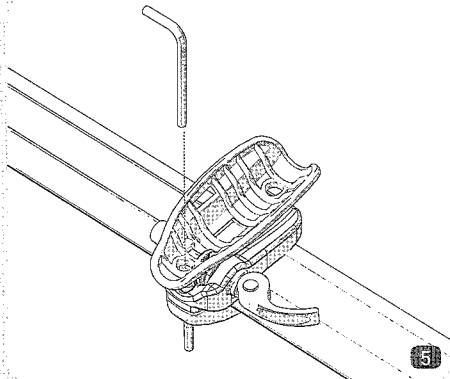
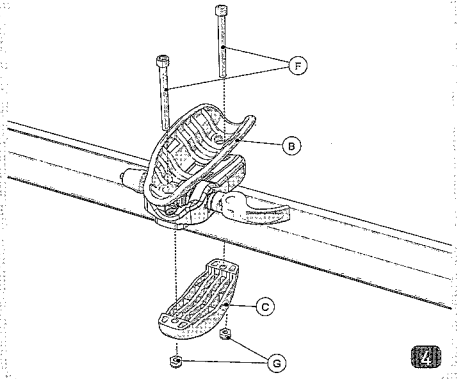
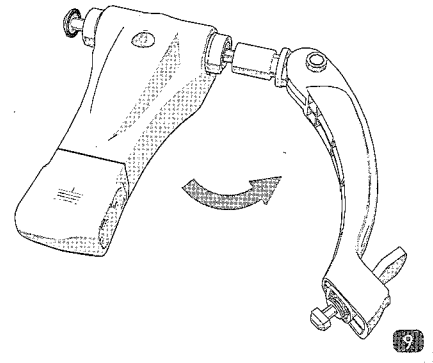
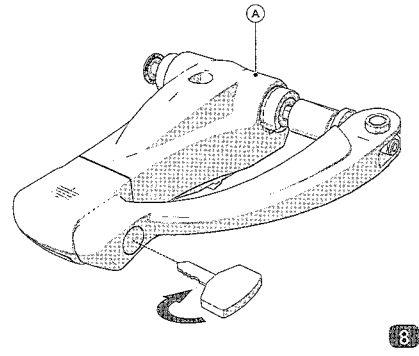
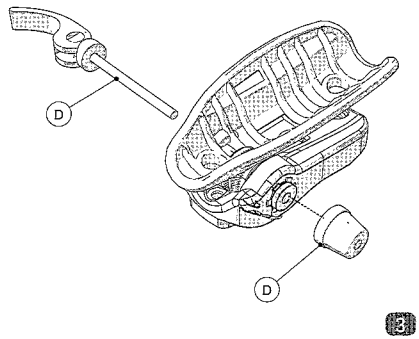
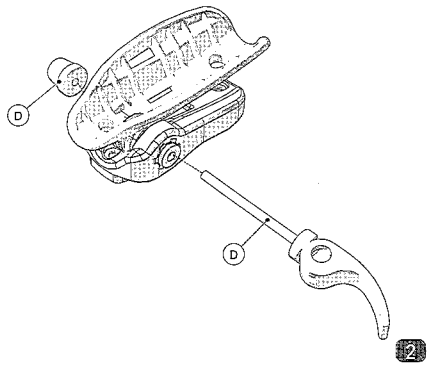

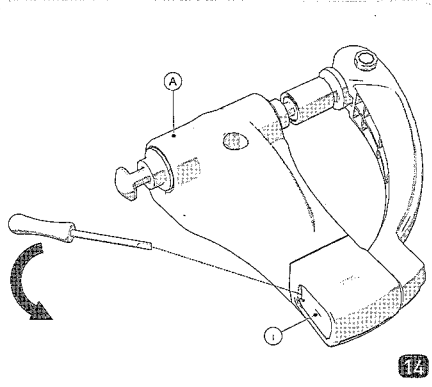

14

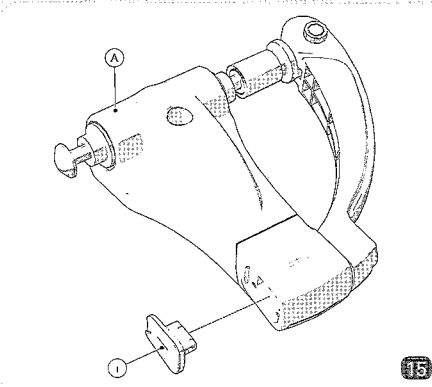

15

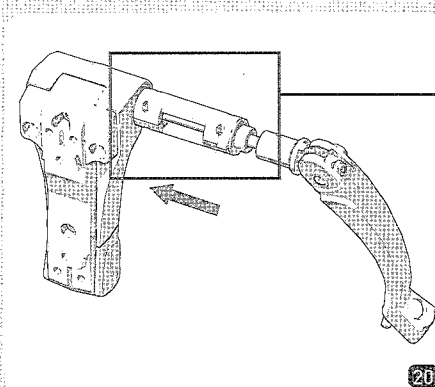

20

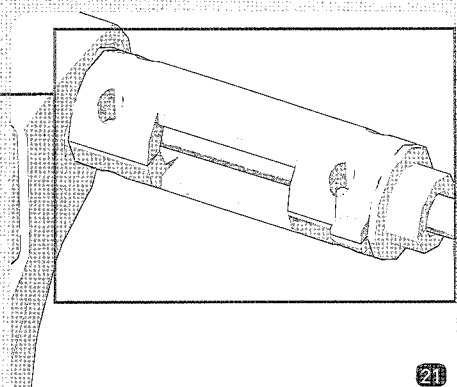

21

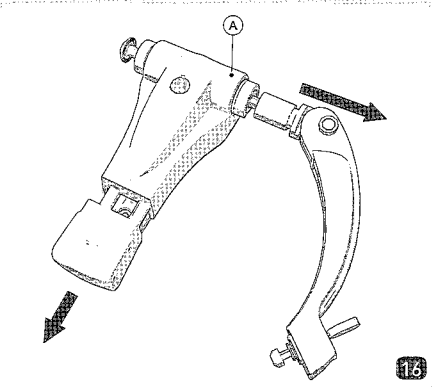

16

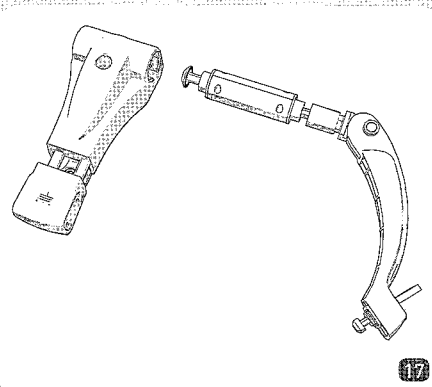

17

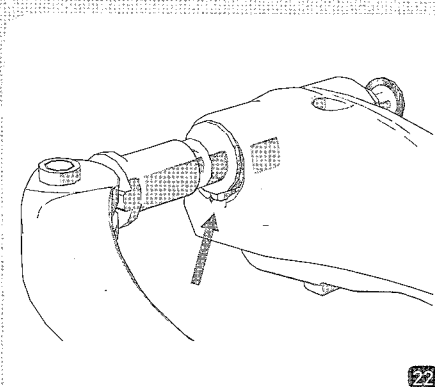

22

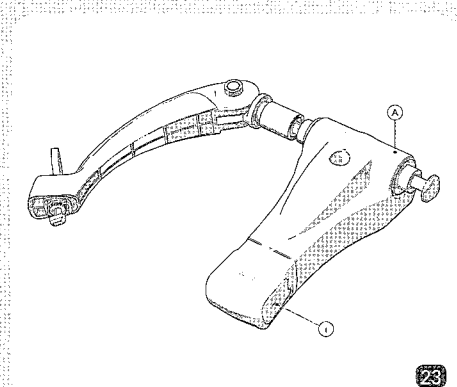

23

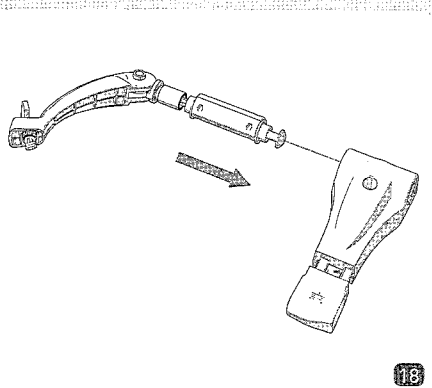

18

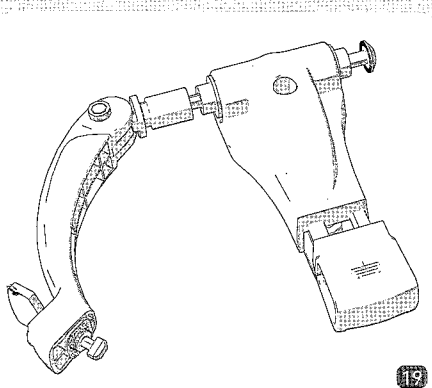

19

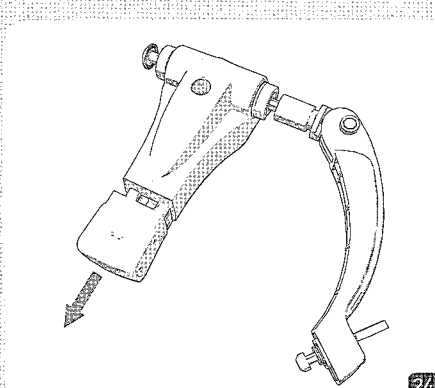

24

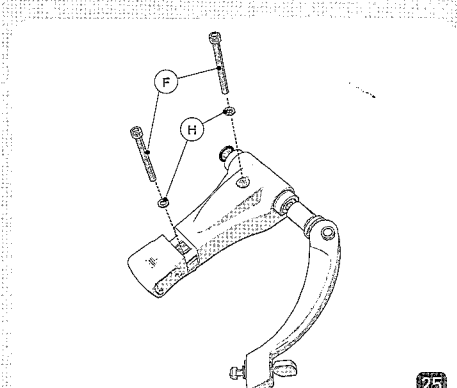

25

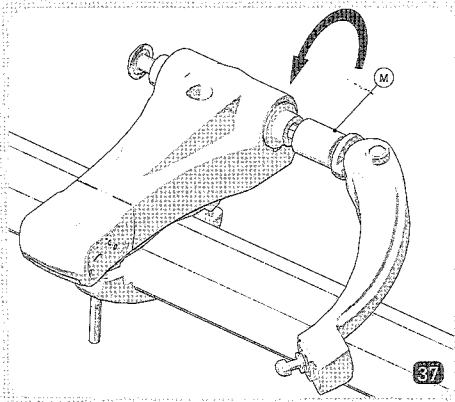
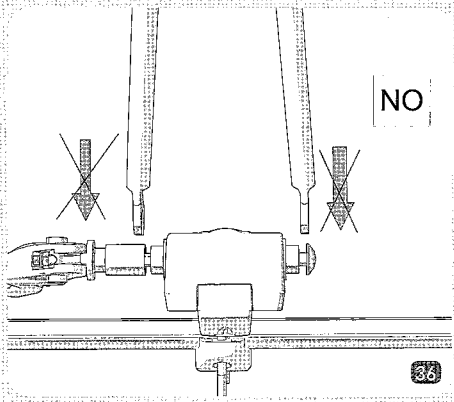
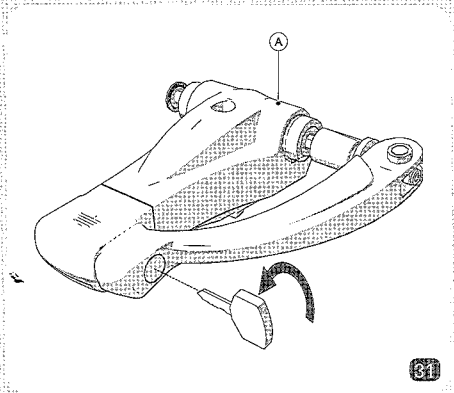
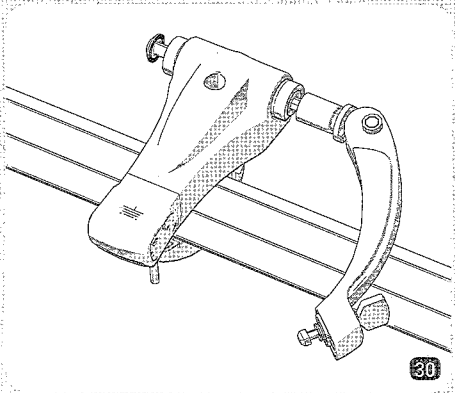
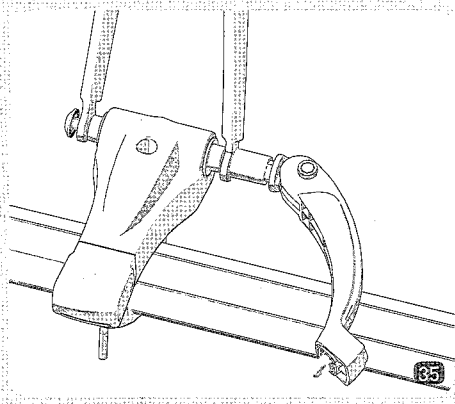
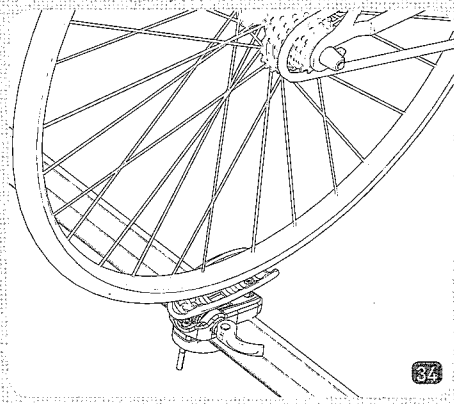
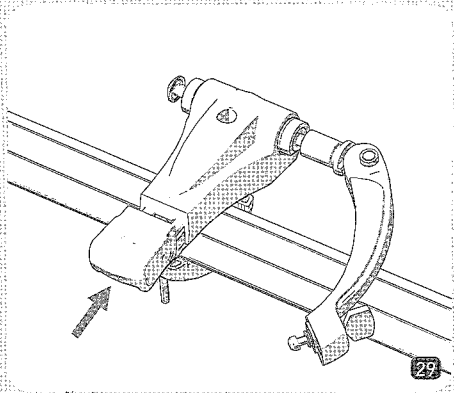
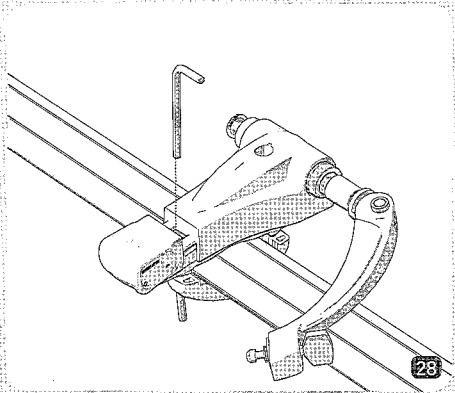
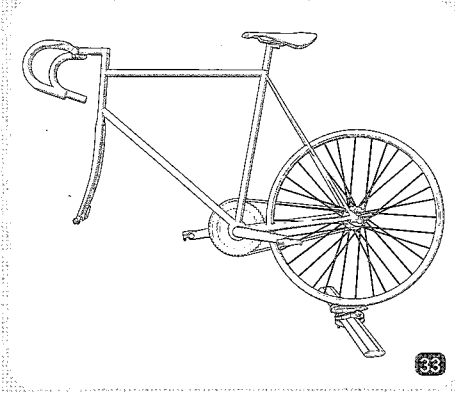
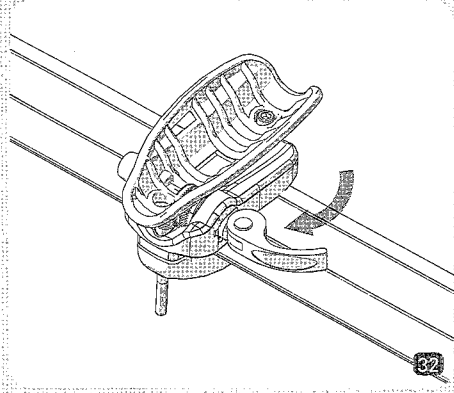
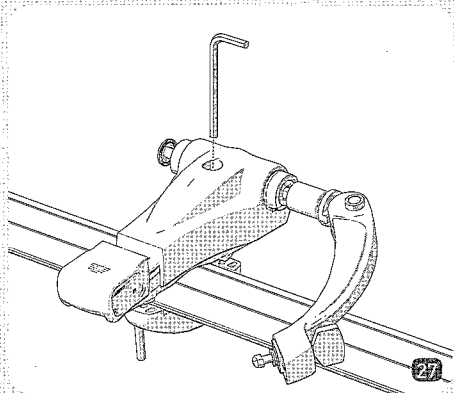
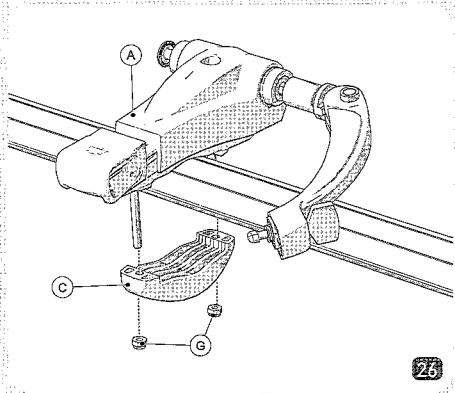

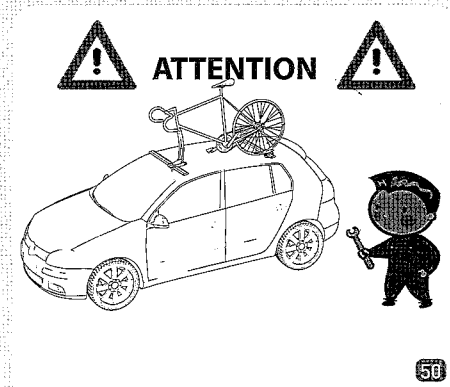
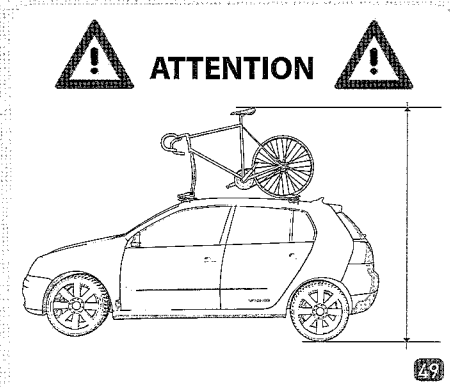
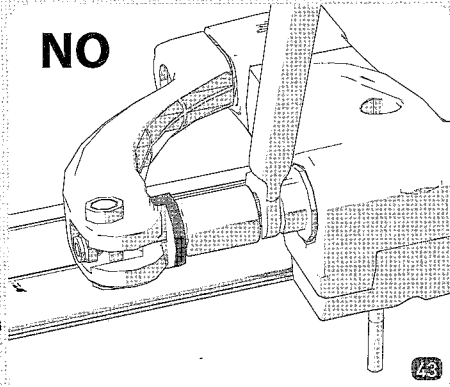
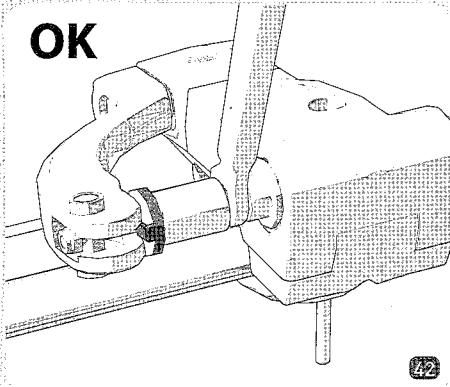
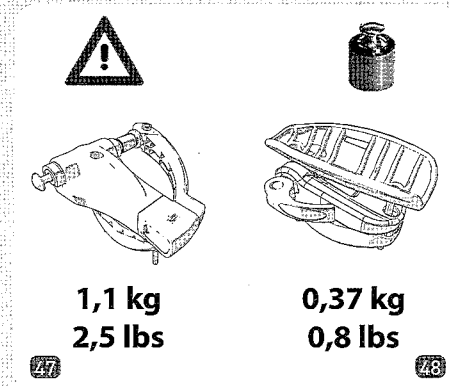
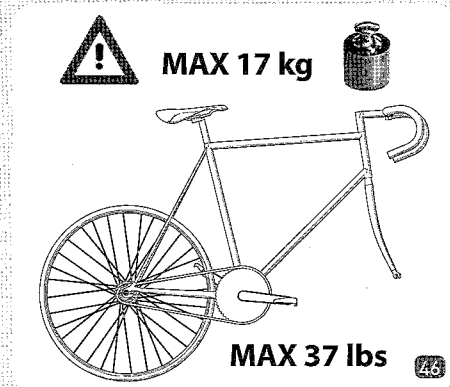
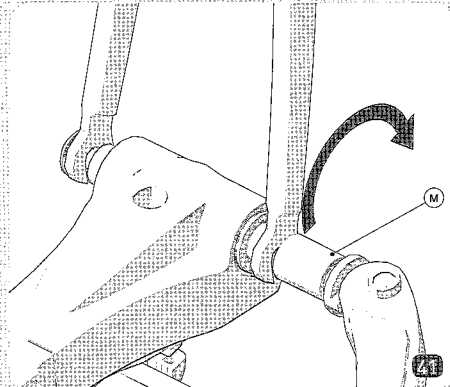
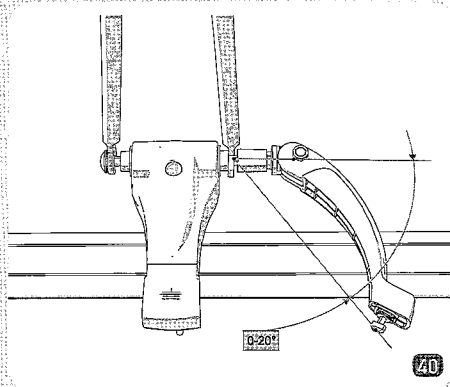
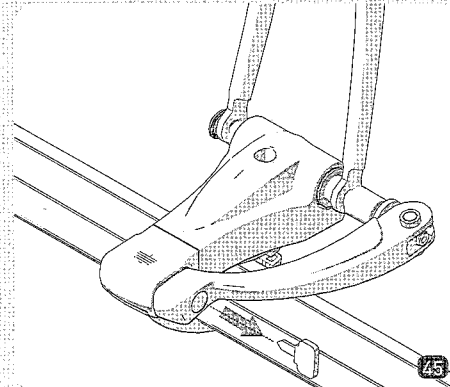
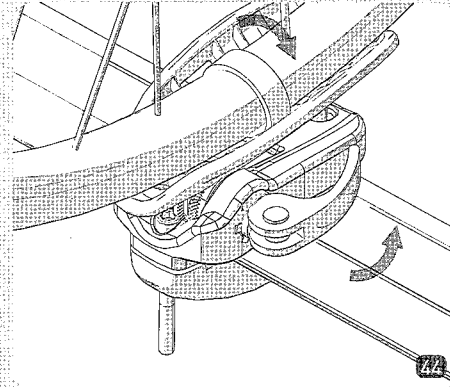
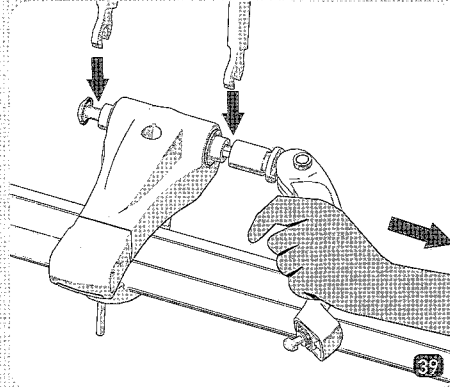
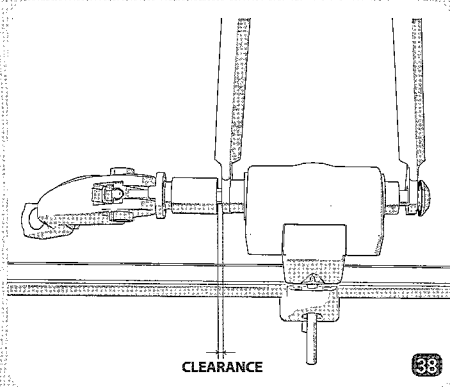

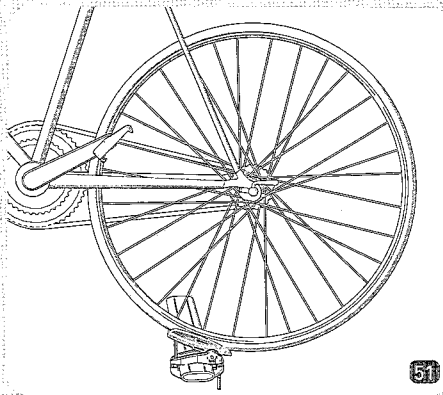

51

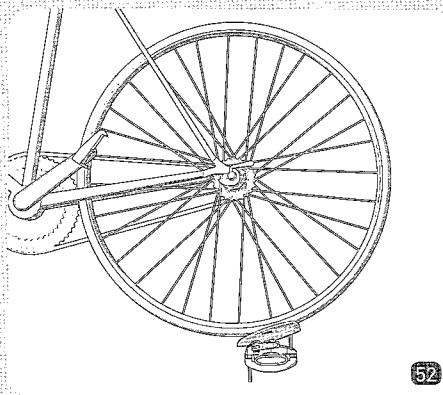

52

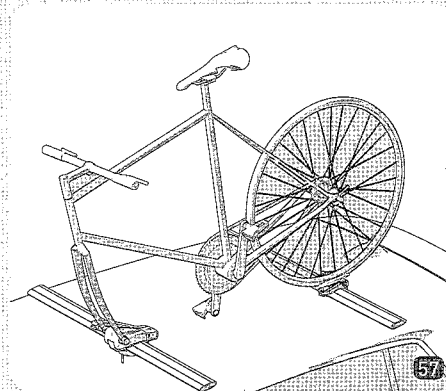

57

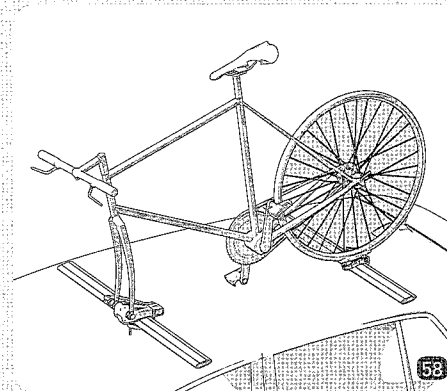

58

MAX 110 km/h
70 mph

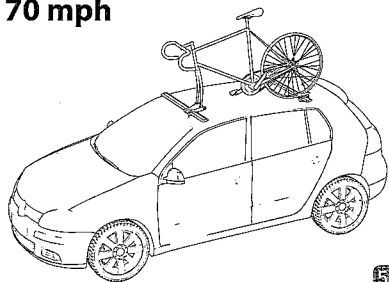

53

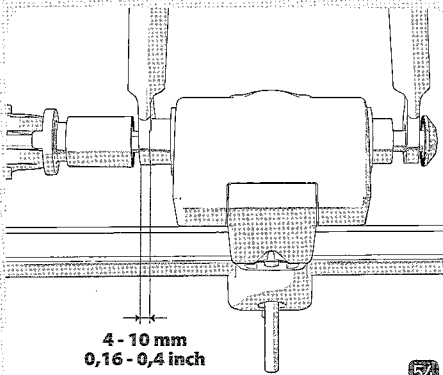

4 - 10 mm
0,16 - 0,4 inch

54

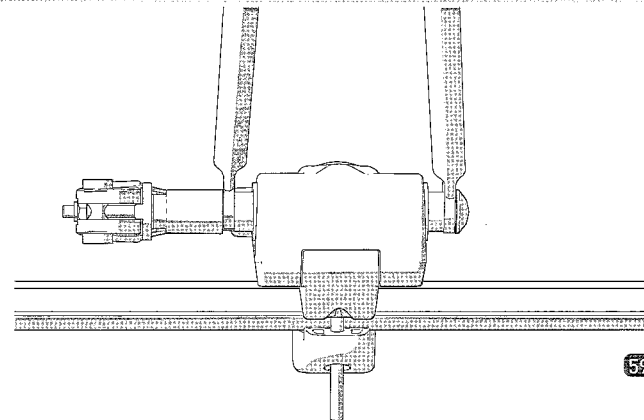

59

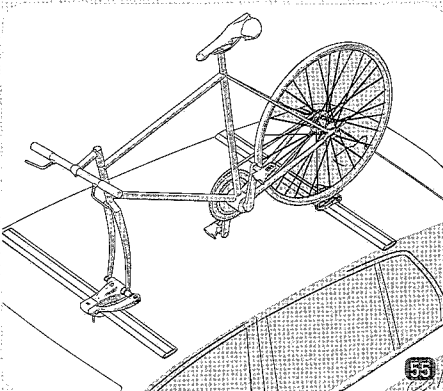

55

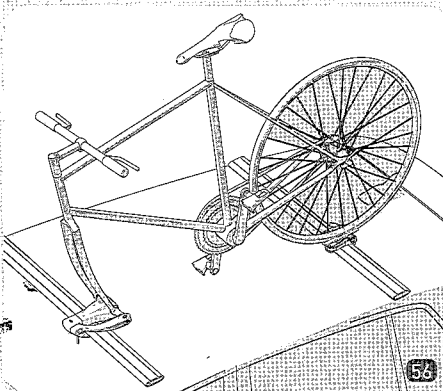

56

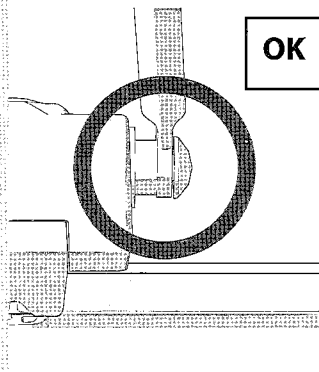

OK

60

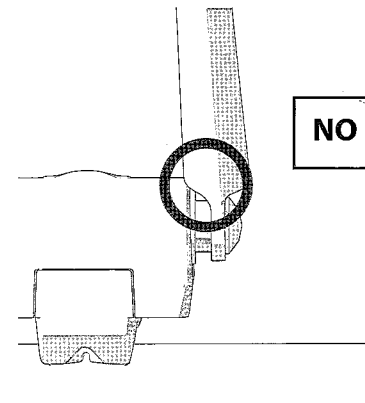

NO

61

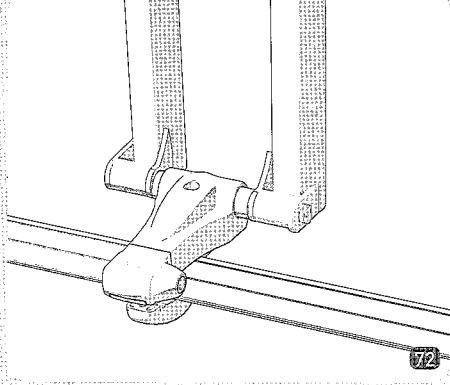
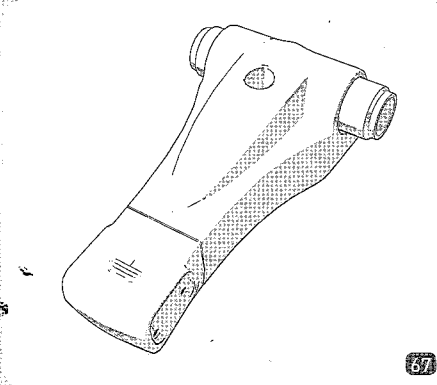
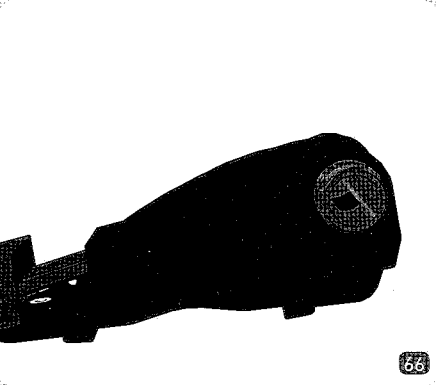
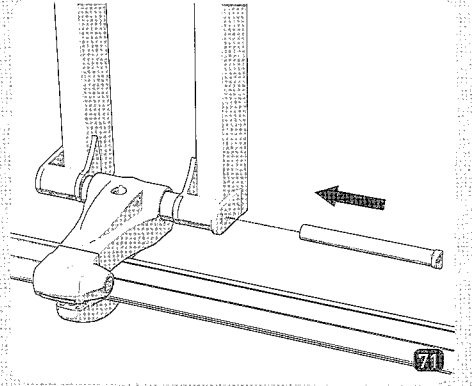
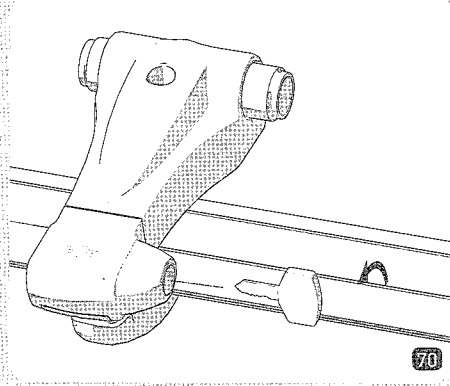
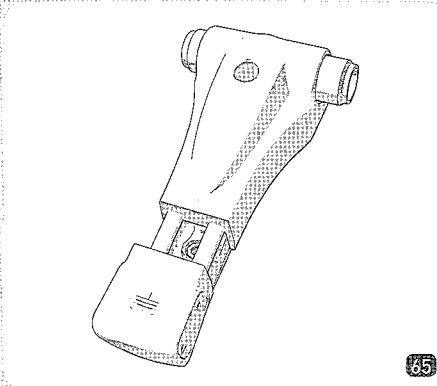
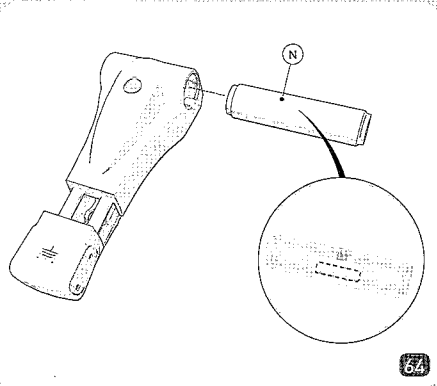
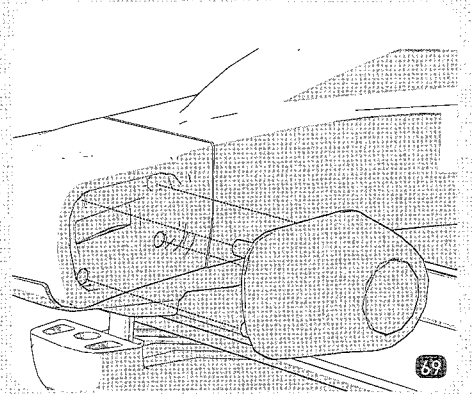
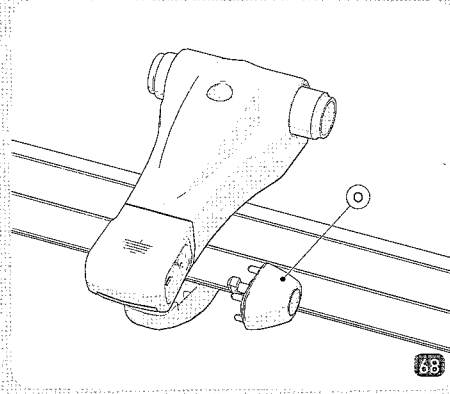
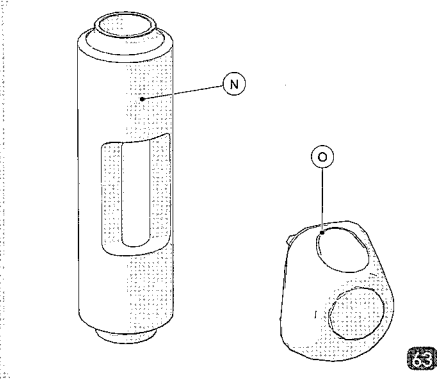
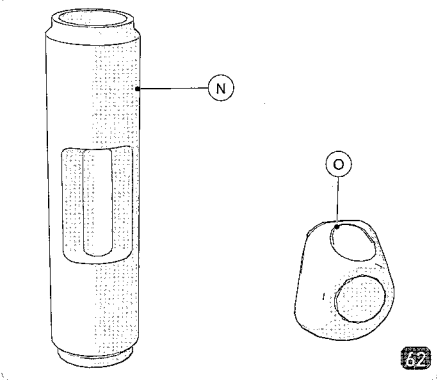

INTRODUZIONE

Grazie per aver scelto di acquistare il nostro Sanremo Race Lock, un supporto per il trasporto di biciclette da montare su barre portatutto a sezione quadra, rettangolare, tonda ed ellittica (larghezza max 80 mm - altezza max 50 mm).

Sanremo Race Lock è composto da un supporto anteriore + supporto posteriore, compatibili con ogni genere di bicicletta, sia da corsa sia da MTB, con freni V-Brake che a disco, con forcelle standard, ammortizzate e in carbonio.

Un'ampia regolazione sul passo fino a 610 mm permette di trasportare qualsiasi taglia di bicicletta, anche su vetture con passo delle barre molto stretto.

Tali caratteristiche lo rendono il più versatile della categoria.

NOME E LISTA DEI COMPONENTI

- N°1 Supporto Anteriore (Rif. A);
- N°1 Supporto Posteriore (Rif. B);
- N°2 Supporto Inferiore (Rif. C);
- N°1 Fissaggio Rapido (Rif. D);
- N°1 Fascetta (Rif. E);
- N°4 Vite M6 (Rif. F);
- N°4 Dado M6 (Rif. G);
- N°2 Rosette M6 (Rif. H);
- N°1 Chiave Esagonale;
- N°2 Chiave Antifurto.

MONTAGGIO

Supporto posteriore:

- È possibile montare il fissaggio rapido (Rif. D) da destra o da sinistra a seconda delle esigenze (Fig. 2 e Fig. 3).
- Con la chiave esagonale in dotazione,

bloccare il supporto posteriore (Rif. B) con il supporto inferiore (Rif. C), interponendo fra i due componenti la barra portatutto (Fig. 4, 5 e 6). Serrare i bulloni fino a completo bloccaggio.

Supporto anteriore:

- Prendere il supporto anteriore (Rif. A) (Fig. 7) e tramite la chiave antifurto sbloccare la maniglia (Fig. 8 e Fig. 9).



ATTENZIONE



- Per facilitare le operazioni di utilizzo, prestare attenzione al senso della maniglia.

Esempio: lato guidatore - maniglia esterna (Fig. 10 e Fig. 11).

Esempio: lato passeggero anteriore - maniglia esterna (Fig. 12 e Fig. 13).

- Se la maniglia non risultasse come nelle figure sopraindicate, dovrete solamente girare la maniglia antifurto verso il lato opposto da quella prestabilita.
- Aiutarsi facendo leva con un cacciavite a taglio per rimuovere il coperchio antifurto (Rif. I) dal supporto anteriore (Rif. A) (Fig. 14 e Fig. 15) ed aprire la leva (Fig. 8 e Fig. 9).
- Portare la slitta anteriore (Rif. L) nella sua massima posizione (Fig. 16), sfilare il blocco maniglia (Fig. 17) ed inserirla nella parte opposta (Fig. 18 e Fig. 19), per far sì che rispetti la corretta posizione tra lato passeggero anteriore - maniglia esterna (Fig. 12 e Fig. 13).

ATTENZIONE!

- Il perno maniglia deve entrare nella rispettiva sede intagliata sull'alluminio del

supporto anteriore (Rif. A) (Fig. 20 e Fig. 21).

- Il perno maniglia deve entrare completamente all'interno del supporto slitta (Rif. A) (Fig. 22).
- Riporre il coperchio antifurto (Rif. I) nel supporto anteriore (Rif. A) esercitando una leggera pressione, in modo che si agganci correttamente.

Eeguire due scatti alla slitta, in modo che ritorni in posizione iniziale (Fig. 23).

- Deciso il lato maniglia, dovrete andare inserire la viteria per il fissaggio dei supporti alla barra.
- Far scorrere in avanti la slitta del supporto anteriore (Rif. A) di uno scatto (Fig. 24), in modo da inserire le viti (Rif. F) e le rosette (Rif. H) all'interno delle rispettive sedi (Fig. 25).
- Con la chiave esagonale in dotazione, bloccare il supporto anteriore (Rif. A) con il supporto inferiore (Rif. C), interponendo fra i due componenti la barra portatutto (Fig. 26, 27 e 28). Serrare i bulloni fino a completo bloccaggio.
- Chiudere la slitta del supporto anteriore (Rif. A) (Fig. 29 e Fig. 30), bloccare la maniglia in sede (Fig. 7) e tramite la chiave antifurto bloccare la maniglia (Fig. 31).

UTILIZZO

- Aprire il fissaggio rapido del supporto posteriore (Rif. B) (Fig. 32).
- Togliere dalla bici la ruota anteriore ed appoggiare la ruota posteriore sopra la culla del supporto posteriore (Rif. B) (Fig. 33 e Fig. 34).
- Con la leva completamente aperta inserire la forcella della bici sul perno del supporto anteriore (Rif. A) prestando attenzione che le forcelle vadano in appoggio senza impedimenti e con la massima libertà (Fig. 35).

• Se ciò non avvenisse (Fig. 36), ruotare la bussola di regolazione (Rif. M) (presente sul supporto anteriore (Rif. A)) nel senso della freccia (Fig. 37) fino a che le estremità della forcella possano entrare liberamente (Fig. 38).

ATTENZIONE: per facilitare l'inserimento della forcella della bici sul perno, tirare con una mano la maniglia fino a che le estremità della forcella possa entrare liberamente (Fig. 39).

- Posizionare la leva maniglia a 0-20° (Fig. 40), se la superficie del supporto anteriore e la forcella sono già in compressione, ruotare la bussola di regolazione (Rif. M) (Fig. 37) fino ad arrivare a 0-20° senza compressione.
- Se posizionando la leva maniglia ed il gioco tra la superficie del supporto anteriore e la forcella risulta maggiore a 0-20° (Fig. 40), ruotare la bussola di regolazione (Rif. M) (Fig. 41) fino ad arrivare a 0-20° gradi senza compressione.
- Chiudere la leva facendo attenzione del corretto posizionamento dell'estremità del perno sulla maniglia (Fig. 42 e Fig. 43) e ruotare la chiave antifurto (Fig. 31).

• Ricordarsi di togliere sempre la chiave prima dell'utilizzo (si consiglia di riporre la seconda chiave in dotazione separatamente dalla prima in modo di avere la possibilità di duplicazione della stessa in caso di smarrimento).

• Fissare la ruota posteriore della bici alla culla del supporto posteriore con la fascetta in dotazione (Rif. E) facendola scorrere nelle apposite fessure. Chiudere il fissaggio rapido (Fig. 44).

CURA E MANUTENZIONE

- Pulire sempre il Sanremo Race Lock dopo l'uso.

- Non usare solventi o detersivi aggressivi.
- Non utilizzare prodotti abrasivi.



ATTENZIONI



- Togliere sempre la chiave prima di avviare la corsa (Fig. 45).
- Controllare il corretto fissaggio della bicicletta dopo i primi Km e successivamente eseguire periodici controlli durante la corsa (Fig. 50).
- Verificare che le parti della bici (cavi e componenti vari) non siano forzati in modo eccessivo durante il montaggio (Fig. 55-56-57-58).

ACCESSORI DI COMPLETAMENTO (solo su richiesta)

- Adattatore per perno passante (Rif. N);
 - Blocchetto chiave (Rif. O);
 - Chiave Antifurto.
- Per bici con perno passante Ø 20 mm, Elite mette a disposizione un perno d'adattamento, un blocchetto chiave e la chiave antifurto (Fig. 62).
 - Per bici con perno passante Ø 15 mm, Elite mette a disposizione un perno d'adattamento, un blocchetto chiave e la chiave antifurto (Fig. 63).

UTILIZZO

- Tenendo in posizione di massima apertura la slitta anteriore, sfilare il blocco maniglia (Fig. 16 e Fig. 17), inserire il perno (Rif. N)

all'interno del supporto anteriore (Rif. A) (Fig. 64) facendo attenzione che la parte con l'intaglio sia rivolta verso il basso (Fig. 65-66-67).

- Per il fissaggio alla barra portatutto seguire il capitolo "MONTAGGIO".
- Portare la slitta nella posizione iniziale ed inserire il blocchetto chiave (Rif. O) al supporto anteriore (Fig. 68).

ATTENZIONE: inserire i pioli del blocchetto all'interno delle rispettive sedi (Fig. 69).

- Tramite la chiave antifurto chiudere il blocchetto maniglia (Fig. 70).
- Togliere dalla bici la ruota anteriore, accostare e trattenere con una mano la forcella della bici all'adattatore per perno passante (Rif. N), inserire ed avvitare il perno passante (Fig. 71).
- Bloccare il perno passante alla forcella (Fig. 72).
- Per il fissaggio della ruota posteriore fare riferimento al capitolo "UTILIZZO".

INTRODUCTION

Thank you for choosing our Sanremo Race Lock, a bike carrier that can be mounted on square, rectangular, round and elliptical bar racks (maximum width 80 mm – maximum height 50 mm).

Sanremo Race Lock has a front support + rear support that's compatible with any kind of bike, both race and MTB, V-Brake or Disc brakes with standard, shock absorbing or carbon forks.

A wide distance adjustment up to 610 mm allows to carry bikes of any size, also on cars with very tight bar distance.

These features make it the most versatile carrier of its kind.

COMPONENTS NAMES AND LIST

- N°1 Front Support (Ref. A);
- N°1 Rear Support (Ref. B);
- N°2 Lower Support (Ref. C);
- N°1 Quick Release (Ref. D);
- N°1 Strap (Ref. E);
- N°4 M6 Screws (Ref. F);
- N°4 M6 Bolts (Ref. G);
- N°2 M6 Washers (Ref. H);
- N°1 Hex key;
- N°2 Anti-theft key.

ASSEMBLY

Rear support:

- It is possible to install the fast fixing mechanism (Ref. D) from the left or the right based on one's needs (pics 2 and 3).
- Lock together the Rear Support (Ref. B) with the Lower Support (Ref. C) by using the supplied Hex key, interjecting the bar rack with the two components (pics 4, 5 and 6). Tighten the bolts until they're com-

pletely locked.

Front support:

- Use the Anti-theft key to unlock the handle (pics 8 and 9) with the Front Support (Ref. A) (pic 7).



WARNING



- Mind the direction of the handle in order to facilitate set up.

Example: driver's side – external handle (pics 10 and 11).

Example: front passenger side – external handle (Pics 12 and 13).

- If the handle does not appear as seen in the previous pictures, just turn the anti-theft handle towards the opposite side from the pre-set one.
- Get some leverage with a screwdriver to remove the anti-theft cover (Ref. I) from the front support (Ref. A) (pics 14 and 15) and open the lever (pics 8 and 9).
- Bring the front slide (Ref. L) to its maximum extension (pic 16), slip the handle block (pic 17) and insert it in the opposite side (pics 18 and 19) in order to set the correct position between front passenger side and external handle (pics 12 and 13).

WARNING!

- The handle pin has to fit in its seating carved in aluminium on the front support (Ref. A) (pics 20 and 21).
- The handle pin has to completely fit in the slide support (Ref. A) (pic 22).
- Put back the anti-theft cover (Ref. I) on the front support (Ref. A) by slightly pressing on it, so that it hooks on correctly.

The slide shall then clock twice and go back to its first position. (pic 23).

- Once you selected the handle side, insert the screws to clamp the supports on the bar.
- Slip forward the front support slide (Ref. A) by one click (pic 24), so that you can insert the screws (Ref. F) and the washers (Ref. H) in their own seatings (pic 25).
- Lock the front support (Ref. A) and the lower support (Ref. C) with the supplied Hex key, by interjecting them with the bar rack (pics 26, 27 and 28). Tighten bolts until they're completely locked.
- Close the front support slide (Ref. A) (pics 29 and 30), lock the handle in its seating (pic 7) with the anti-theft key (pic 31).

USE

- Release the fast fixing mechanism of the rear support (Ref. B) (pic 32).
 - Remove the front wheel of the bike and place the rear wheel above the cradle of the rear support (Ref. B) (pics 33 and 34).
 - Open the lever completely and place the fork of the bike on the front support pin (Ref. A) – the fork has to lean freely and without obstructions (pic 35).
 - If that doesn't happen (pic 36), turn the adjusting bush (Ref. M) on the front support (Ref. A) facing the direction of the arrow (pic 37) until both edges of the fork can be inserted without obstructions (pic 38).
- ATTENTION:** to facilitate insertion of the bicycle fork on the pin, pull the handle with one hand until the ends of the fork can enter freely (Fig. 39).
- Place the handle lever at 0-20° (pic 40) and turn the adjusting bush (Ref. M) (pic 37) until it gets to 0-20° without coming into contact if the surface of the front support and the

fork are already touching.

- If the distance between surface of the front support and fork is more than 0-20° (pic 40) while positioning the handle lever, turn the adjusting bush (Ref. M) (pic 41) until it gets to 0-20° without coming into contact.
- Close the lever and place correctly the edge of the pin on the handle (pic 42 and 43) and turn the anti-theft key (pic 31).
- Remember to always remove the key before use (we suggest to store separately the spare key we supply in order to have it ready in case you misplace the first one).
- Position the rear wheel of the bike on the cradle of the rear support with the supplied strap (Ref. E) by making it slide into its proper slots. Close the fast fixing mechanism (pic 44).

MAINTENANCE

- Always clean the Sanremo Race Lock after use.
- Do not use solvents or strong detergents.
- Do not use products with abrasive substances.



WARNING



- Always remove the key before the race.
- After the first few miles check the correct positioning of the bike and do so periodically to time while travelling (pic 50).
- Check that bike parts (cables and other components) are not excessively constrained when assembling (pics 55-56-57-58).

OTHER ACCESSORIES (only on demand)

- Pivot Pin adapter (Ref. N);

ELITE

- Key Block (Ref. O);
- Anti-theft key.

• For bikes with Ø20 mm pivot pin, ELITE supplies an adjusting pin, a key block and the anti-theft key (pic 62).

• For bikes with Ø15 mm pivot pin, ELITE supplies an adjusting pin, a key block and the anti-theft key (pic 63).

USE

- Slide the handle block (pics 16 and 17) by keeping the front slide as open as possible, and slide the pin (Ref. N) inside the front support (Ref. A) (pic 64) making sure that the carved part is facing down (pics 65, 66 and 67).
- See chapter "ASSEMBLY" for installation on bar rack.
- Move the slide on the initial position and insert the key block (Ref. O) on the front support (pic 68).

ATTENTION: insert the pins of the block inside their proper housings (pics 69).

- Close the handle block with the anti-theft key (pic 70).
- Remove the front wheel from the bicycle, hold the bicycle fork with one hand and bring it near the adapter for through pin (Ref. N), insert and screw the through pin (Fig.71).
- Secure the through pin to the fork (Fig. 72).
- See chapter "USE" for rear wheel fastening.

ELITE